



## Desk2Device USB Charger Data sheet

# Desk2Device USB Charger

---

The Desk2Device USB Charger is a charging unit with one USB Type-A and two USB Type-C connector outputs. As the charger is connected to the Control Box CBD6S, it draws power directly from the desk and no extra power supply is needed.

The charger can charge devices such as mobile phones, laptops, power banks, headsets, and other accessories, and it helps reduce cable clutter and provides better power access.

The Desk2Device USB Charger comes with two different mounts (flat and angled) and offers different mounting options. Choose between C-clamp (accessory) for mounting on top of the desk, or screws for mounting under the tabletop.

The Desk2Device USB Charger comes without power and charging cables. Connect your preferred DC-bus cable to the Desk2Device USB Charger and to the control box to supply power to the charger..



---

## Features:

- One USB Type-A port (output 7.5 W)
- Two USB Type-C ports (output 50 W if one port is used; 25 W each if both ports are used)
- Colour: Housing: signal white (RAL 9003)  
Mounts: black (RAL 9005)
- Mounting on top of the tabletop or underneath the tabletop (horizontal or slightly tilted)
- Comes with two different mounts, and a rubber (silicone) pad to secure placement on a smooth desk surface
- Dimensions: 95 mm x 50 mm x 20 mm
- Weight: 85 g
- Low standby power consumption – only 0.1 W (ZERO™)
- LED diodes indicate either charging or that an active device is connected
- PVC-Free™

## Accessories:

- C-clamp for mounting on top of the desk

## Usage:

- Fast charge  
(charging time typically 1 to 1.5 hours for a smartphone)
- For indoor use in dry locations
- Ambient temperature: 5 to 40 °C
- Storage temperature: -10 to +50 °C
- Compatible with CBD6S (200 W and 300 W; 300 W must be SW version 1.53 or newer)
- Compatible with cable CAB0965388 and all DESKLINE DC-bus cables
- Compatible with Battery Box BA001
- Complies with UL 62368, FCC, EN61000 and EN60335



No data can be transferred via the charger.

Dimensional drawings

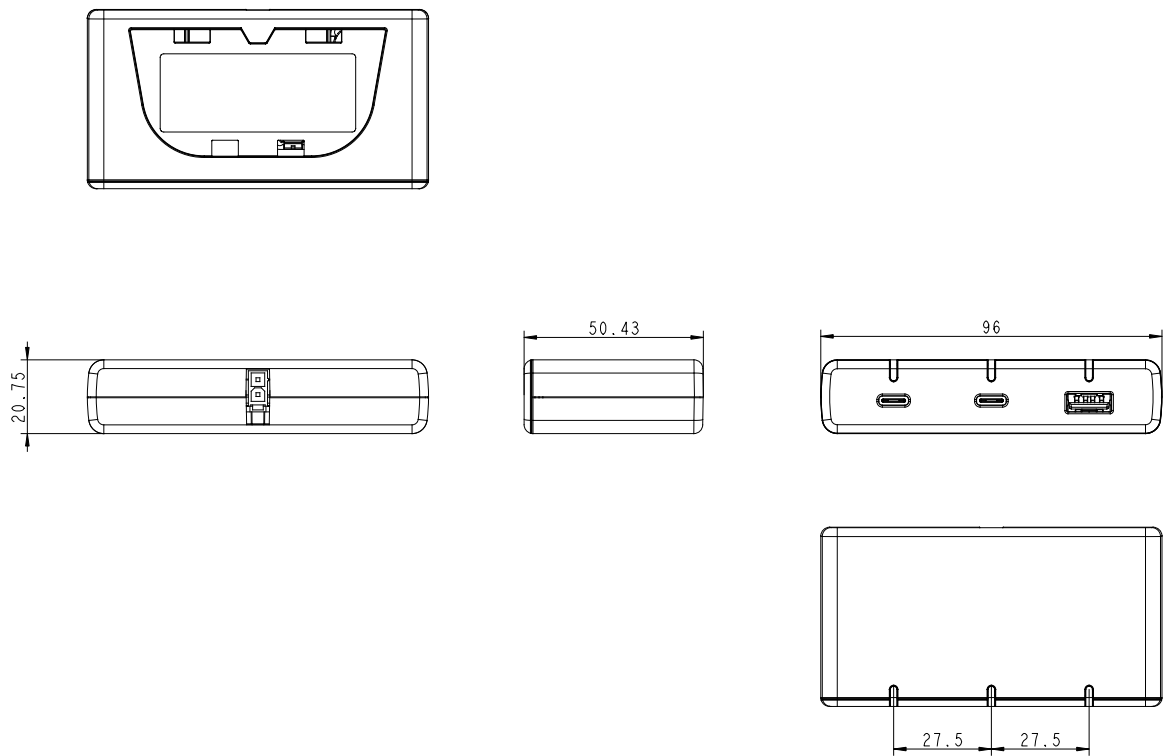

Desk2Device USB Charger dimensions (mm)

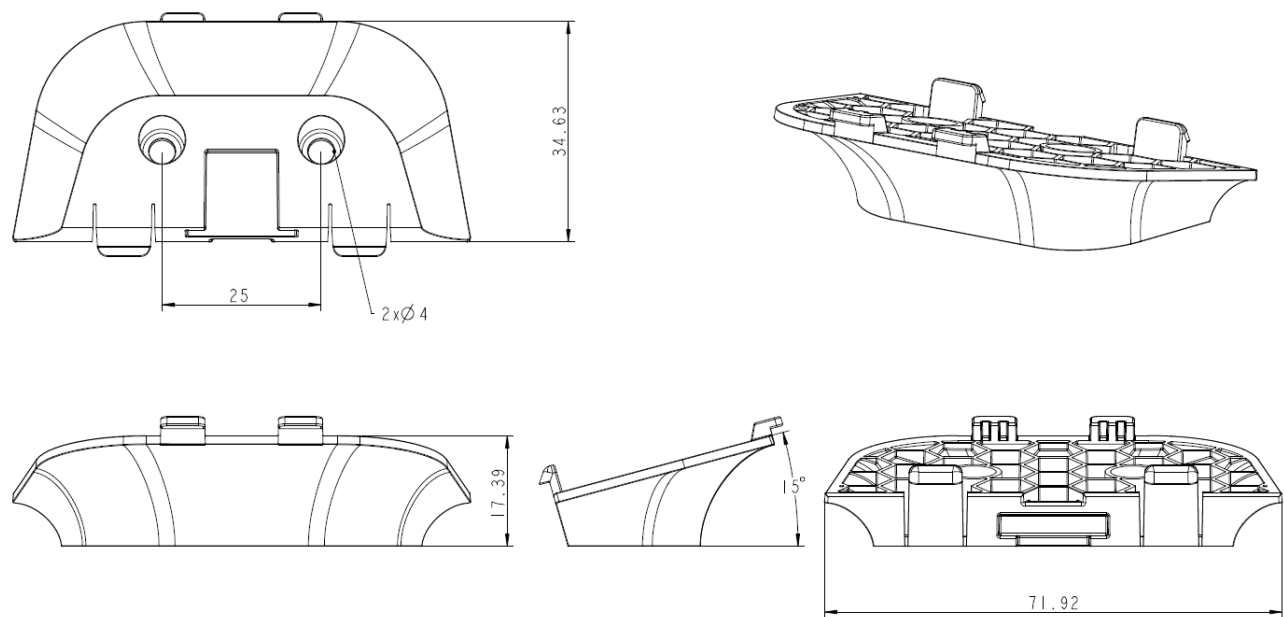

Angled mount dimensions (mm)

Dimensional drawings

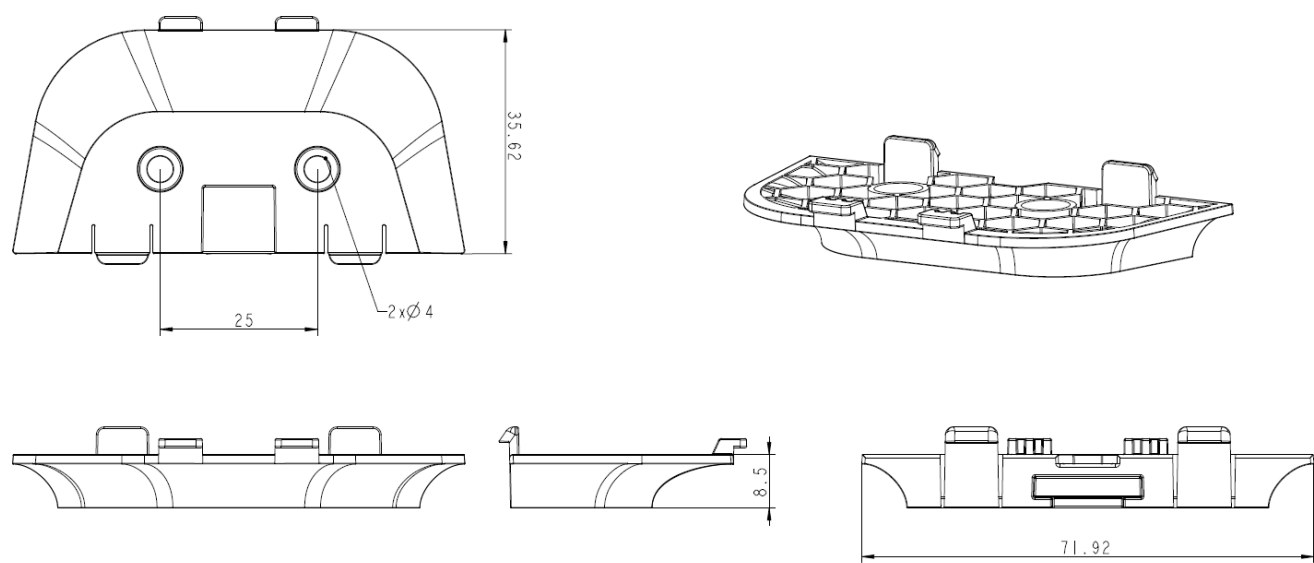

Flat mount dimensions (mm)

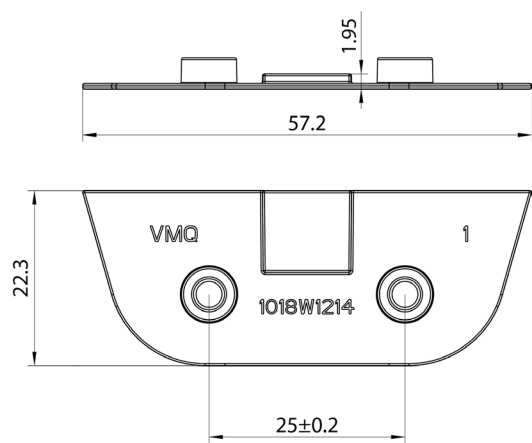

Rubber pad dimensions (mm)

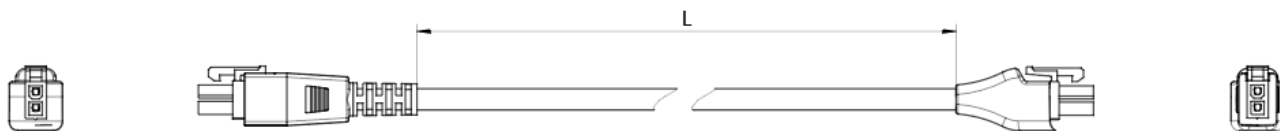

Item number	Length (L)
CAB0965388-1800	1800 mm

Dedicated cable

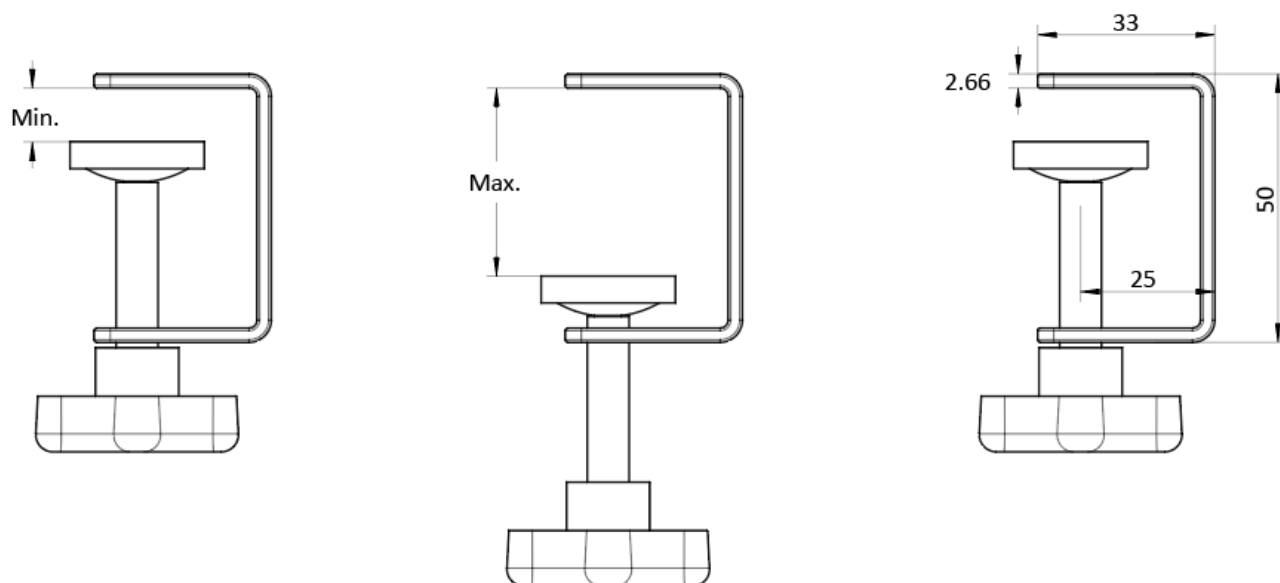

Min.	$10 \pm 5$ mm
Max.	$35 \pm 5$ mm

C-clamp dimensions (mm)

Desk2Device USB Charger

Ordering example:

Desk2Device USB Charger	CHUSB	
Port type	<div>C</div>	C = USB Type-C port
Number of C ports	<div>2</div>	2 = 2
Port type	<div>A</div>	A = USB Type-A port
Number of A ports	<div>1</div>	1 = 1
Option	<div>-</div>	- = Standard
Colours	<div>0</div>	0 = White housing, black mounts
Input source	<div>0</div>	0 = LINAK DC bus
Cable *	<div>0</div>	0 = No cable
Chosen item number: CHUSBC2A1-000		

\*: Use a detachable cable - either the dedicated cable CAB0965388 or any LINAK standard DC-bus cable.

Please order the Desk2Device USB Charger in quantities of 40 pieces. 40 pieces fit in one box.

Cable and C-clamp

Product	Item number	Description
Cable	CAB0965388-1800	Dedicated cable; length 1800 mm
C-clamp	SA1018W1212	C-clamp for mounting the charger

LINAK® accepts no responsibility for possible errors or inaccuracies in catalogues, brochures, and other material. LINAK reserves the right to change its products without prior notice. LINAK cannot guarantee product availability and reserves the right to discontinue the sale of any product. The user is responsible for determining the suitability of LINAK products for a specific application. All sales are subject to the 'Standard Terms of Sale and Delivery', available on LINAK websites.

LINAK and the LINAK logotype are registered trademarks of LINAK A/S. All rights reserved.